

Rubber Expansion Joint

SPECIFICATIONS:

- Working Pressure 1.6
- Bursting Pressure 5000kPa
- Angle of Deflection 15°
- Vacuum kPa(mmHg) 86.7(650)
- Applicable Temp -10~120°C
- Applicable Media Air, Compressed, Water, Weak Acid, Alkali, etc
- Table "E"
- FBE - Flanges

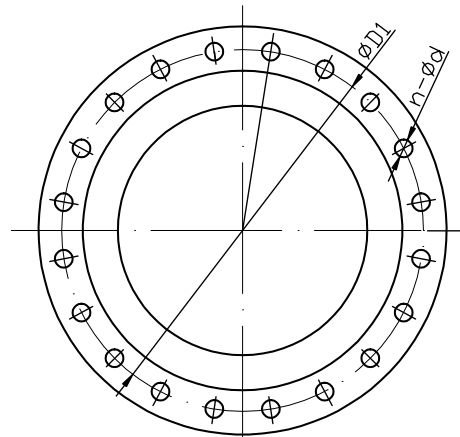
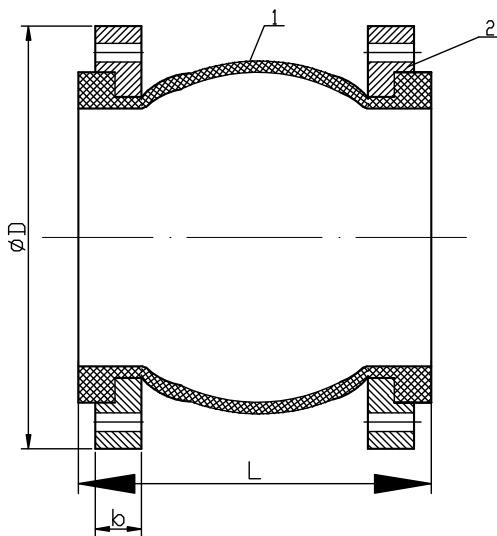

DIMENSIONS:

SIZE		L	TABLE E			AXIAL		LATERAL DEFLECTION	ANGULAR DEFLECTION	b
in	DN		D	D1	n-d	ELONGATION	COMPRESSION			
2	50	105	150	114	4-18	7	10	10	15	14
2 1/2	65	115	165	127	4-18	7	13	11	15	16
3	80	135	185	146	4-18	8	15	12	15	16
4	100	150	215	178	8-18	10	19	13	15	18
5	125	165	255	210	8-18	12	19	13	15	20
6	150	180	280	235	8-22	12	20	14	15	20
8	200	210	335	292	8-22	16	25	22	15	20
10	250	230	405	356	12-22	16	25	22	15	22
12	300	245	455	406	12-26	16	25	22	15	23



AVG WA (Head Office)
Unit 2, 9-11 Noble St,
Kewdale, WA, 6105
Fax: +61 8 9353 2689

Tel: 1800 AVG AUS (284 287)
www.avg.net.au

